



JLAB  
WORK  
BUDS

We love that you are rocking JLab!  
We take pride in our products and fully stand behind them.



#### YOUR WARRANTY

All warranty claims are subject to JLab authorization and at our sole discretion. Retain your proof of purchase to ensure warranty coverage.



#### CONTACT US

Reach out to us at [support@jlab.com](mailto:support@jlab.com) or visit [jlab.com/contact](http://jlab.com/contact)

### REGISTER TODAY

[jlab.com/register](http://jlab.com/register)

Product updates | How-to tips  
FAQs & more

## PAIR UP

- 1 Take earbuds out of dock and remove stickers. Place earbuds back in charging dock and plug in.

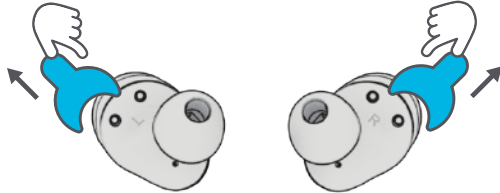

- 2 Blue lights on case indicates charging. Remove earbuds from case.

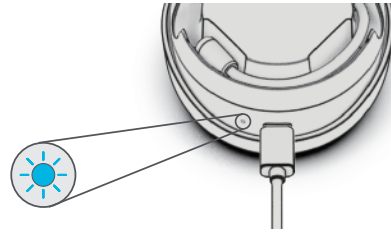

- 3 One earbud will blink blue/white indicating ready to pair to your device. Select "JLab Work Buds" in your device's Bluetooth settings.

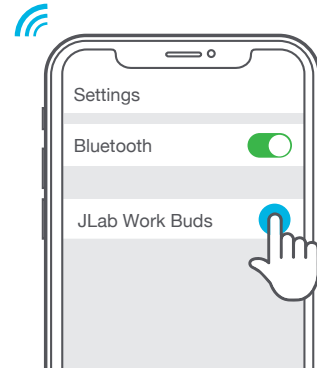
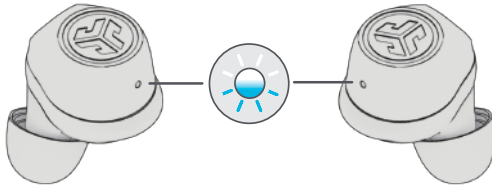

## PICK A SIDE

Swap boom mic into either earbud.

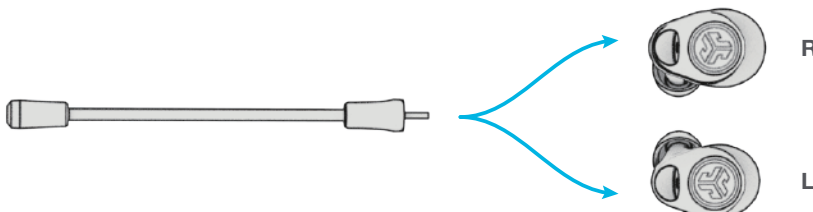

## FIND YOUR FIT

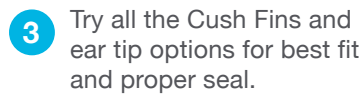
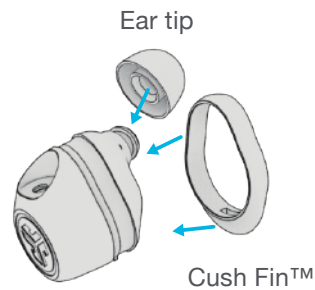

## ANY WHICH WAY

Leave mic ready between calls or fold up for travel. Flip dock to secure earbuds for travel.

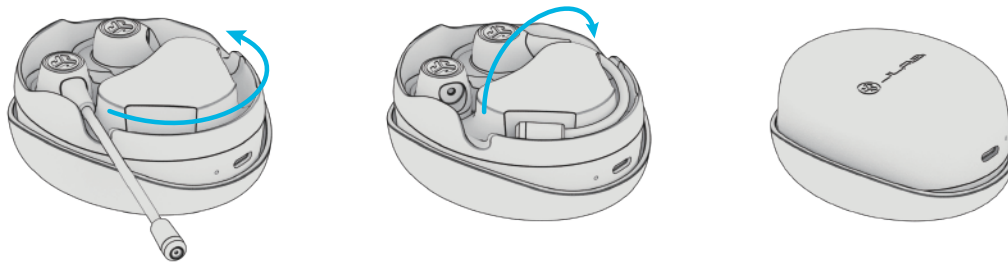

## GO AHEAD, PRESS THE BUTTON



**VOLUME DOWN:** 1x Tap  
**SIRI (iOS) or "OK GOOGLE" (ANDROID):** 2x Tap  
**CHANGE EQ:** 3x Tap (cycles EQ settings)  
**MUSIC / MOVIE MODE:** Press & hold 1+ sec  
**ANSWER CALL:** 1x Tap  
**HANGUP CALL:** Press & hold 1+ sec  
**REJECT INCOMING CALL:** Press & hold 1+ sec

**VOLUME UP:** 1x Tap  
**PLAY / PAUSE:** 2x Tap  
**BE AWARE:** 3x Tap (cycles 2 sound settings)  
**TRACK FORWARD:** Press & hold 1+ sec  
**ANSWER CALL:** 1x Tap  
**HANGUP CALL:** Press & hold 1+ sec  
**REJECT INCOMING CALL:** Press & hold 1+ sec

## GET CHARGED (EARBUDS)

Placing in the charging dock will auto power OFF and start charging. Earbuds LEDs will **pulse blue** when charging and will turn OFF when fully charged.

Removing the earbuds will auto power ON and connect to last device. To turn off without case, disconnect Bluetooth from device. Earbuds will power off after 3 minutes.

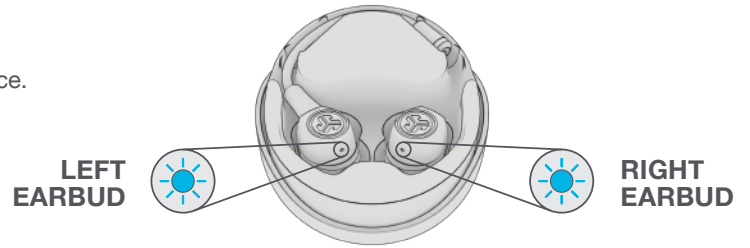

## GET CHARGED (DOCK)

Connect the JLab Work Buds to computer or USB 5V 1A (or less) output device.

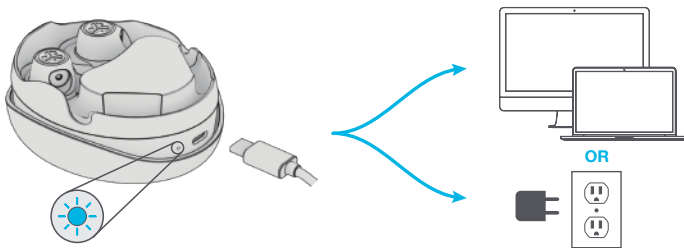

LED **pulses blue** when charging and **turns solid blue** when fully charged.

## MULTIPOINT (connect 2 devices simultaneously)

- 1 Once **FIRST** device is connected, turn off Bluetooth in device settings. Earbuds will auto enter Bluetooth Pairing.



- 2 Enter your **SECOND** device Bluetooth settings and connect to JLab Work Buds.

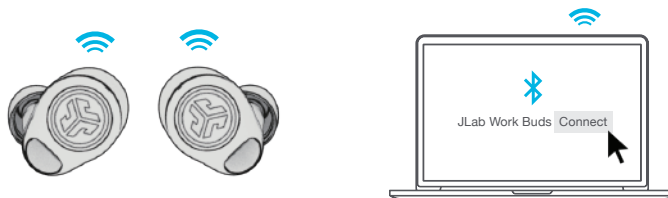

- 3 Enter your **FIRST** device Bluetooth settings. Turn on Bluetooth and connect to JLab Work Buds.



## THE RIGHT SOUND FOR EVERY MOMENT

We get it, sound is personal. Choose your sound preferences from our EQ3 settings and customize your sound style to match exactly what you're doing.

### EQUALIZER MODES



**JLab SIGNATURE**  
JLab C3™ signature sound with amplified vocals and bass

**BEST FOR**  
Best option for most music Pop, rock, country, electronic and more



**BALANCED**  
Even sound with no additional enhancements

**BEST FOR**  
Podcasts, Audiobooks  
Classical music



**BASS BOOST**  
Amplified bass and sub-bass

**BEST FOR**  
Working out, sport and fitness  
Hip hop, rap, electronic



**"CUSTOM"**  
Custom EQ setting

(download the **JLab App** to customize).

### QUICK TIPS

- Either earbud can connect to your device and be used independently. Simply take out the earbud from charging case and it will auto connect.
- Earbuds can be used with or without boom mic, but the mic will improve the quality of your voice and reduce background sound in clear voice mode.
- Choosing the correct ear tip makes a significant improvement in audio quality due to proper seal for the driver. Try all ear tips for best results.

### VOICE PROMPTS

**"Ready to Pair"**: Work Buds are ready to pair to Bluetooth device

**"Battery Full"**: 100-80%

**"Battery Medium"**: 80-20%

**"Low Battery"**: Less than 20%

When power decreases to 10%, "Low Battery" will play

### DOWNLOAD THE APP

Customize JLab Work Buds features and update the latest software.

Download the **JLab App** in Apple/Google Play Store.



## TROUBLESHOOTING

### NO AUDIO IN ONE EARBUD OR EARBUDS DISCONNECTED (MANUAL RESET)

- 1 Keep earbuds in the charging dock and forget "JLab Work Buds" in your Bluetooth device settings.

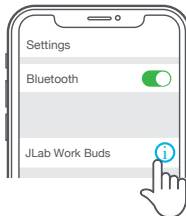

- 2 Quick tap 7x on one earbud in charging case. Earbud blinks blue 4 times.

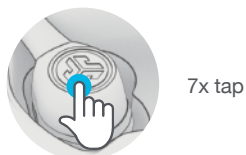

- 3 Quick tap 7x on other earbud in charging case. Earbud blinks blue 4 times.



- 4 Take both earbuds out of the charging case. One earbud will blink blue/white indicating ready to pair to your device.



[Shop products](#) | [Product alerts](#) | [Burn-in your headphones](#)

JLab Store + Burn-in Tool

